

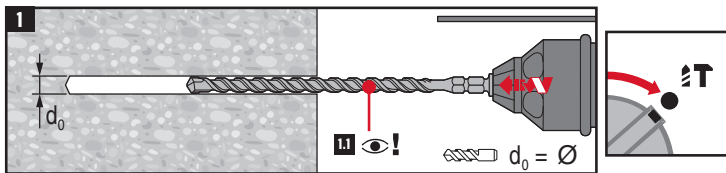

\emptyset KWIK-CON	d_f [inch]
	
1/4	5/16
3/16	1/4

[inch]	h_1 [inch]	t_{fix} [inch]
1 1/4	1 3/4 - t _{fix}	0 ... 1/4
1 3/4	2 1/4 - t _{fix}	0 ... 3/4
2 1/4	2 3/4 - t _{fix}	0 ... 1 1/4
2 3/4	3 1/4 - t _{fix}	0 ... 1 3/4
3 1/4	3 3/4 - t _{fix}	0 ... 2 1/4
3 3/4	4 1/4 - t _{fix}	0 ... 2 3/4
4	4 1/2 - t _{fix}	0 ... 3

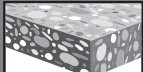
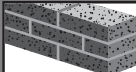

1.1	\emptyset KWIK-CON	$\emptyset d_0$ [inch]		
				
	3/16 inch	3/16 Kwik-Con II+ Drill Bits	438630 (TE-C SDS) 438634 (Smooth Shank)	438631 (TE-C SDS) 438635 (Smooth Shank)
	1/4 inch	1/4 Kwik-Con II+ Drill Bits	438628 (TE-C SDS) 438632 (Smooth Shank)	438629 (TE-C SDS) 438633 (Smooth Shank)

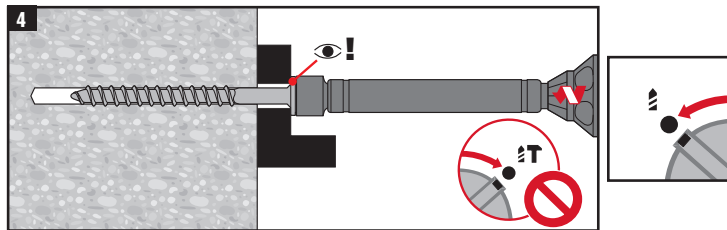
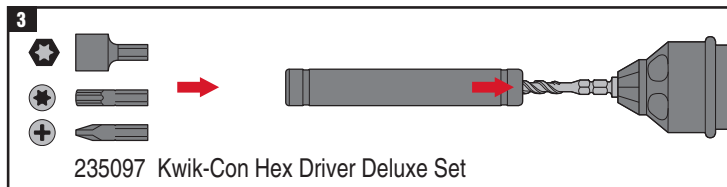
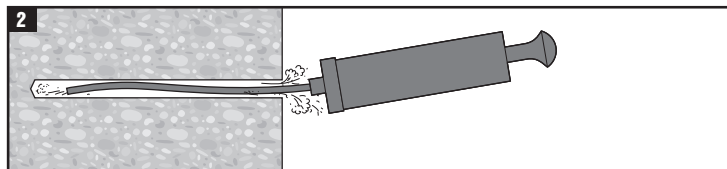

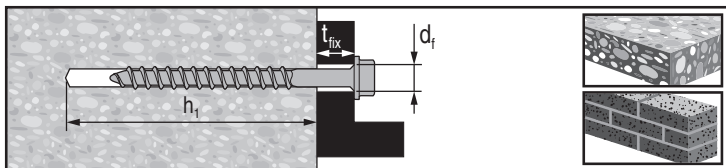

Ø KWIK-CON	d_f [mm]
6.4	8
4.8	6.5

[mm]	h_1 [mm]	t_{fix}
32	44 - tfix	0...6mm
44	57 - tfix	0...18mm
57	70 - tfix	12...31mm
70	83 - tfix	25...44mm
83	95 - tfix	38...57mm
95	108 - tfix	50...69mm
102	114 - tfix	57...76mm

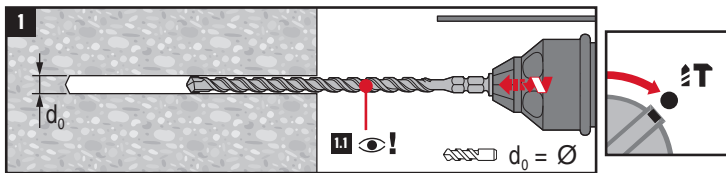

1.1 Ø KWIK-CON

4.8mm	Kwik-Con II+ Drill Bits	438630 (TE-C SDS)	438631 (TE-C SDS)
		438634 (Smooth Shank)	438635 (Smooth Shank)
6.4mm	Kwik-Con II+ Drill Bits	438628 (TE-C SDS)	438629 (TE-C SDS)
		438632 (Smooth Shank)	438633 (Smooth Shank)

